

**NOTES:**

- 1) EXACT MOUNTING DETAILS TO BE DETERMINED AT JOBSITE BY OTHERS.
- 2) CALCULATIONS DO NOT SHOW THE EFFECT OF SHADOWING CAUSED BY OBJECTS WITHIN THE AREA.

**BASEBALL TYPICAL  
BABE RUTH & SEN. LEAGUE  
CLASS IV, 6 OUTFIELD POLES  
300' RADIUS, 90' BASELINE  
REF. NO. BASEIV630090**

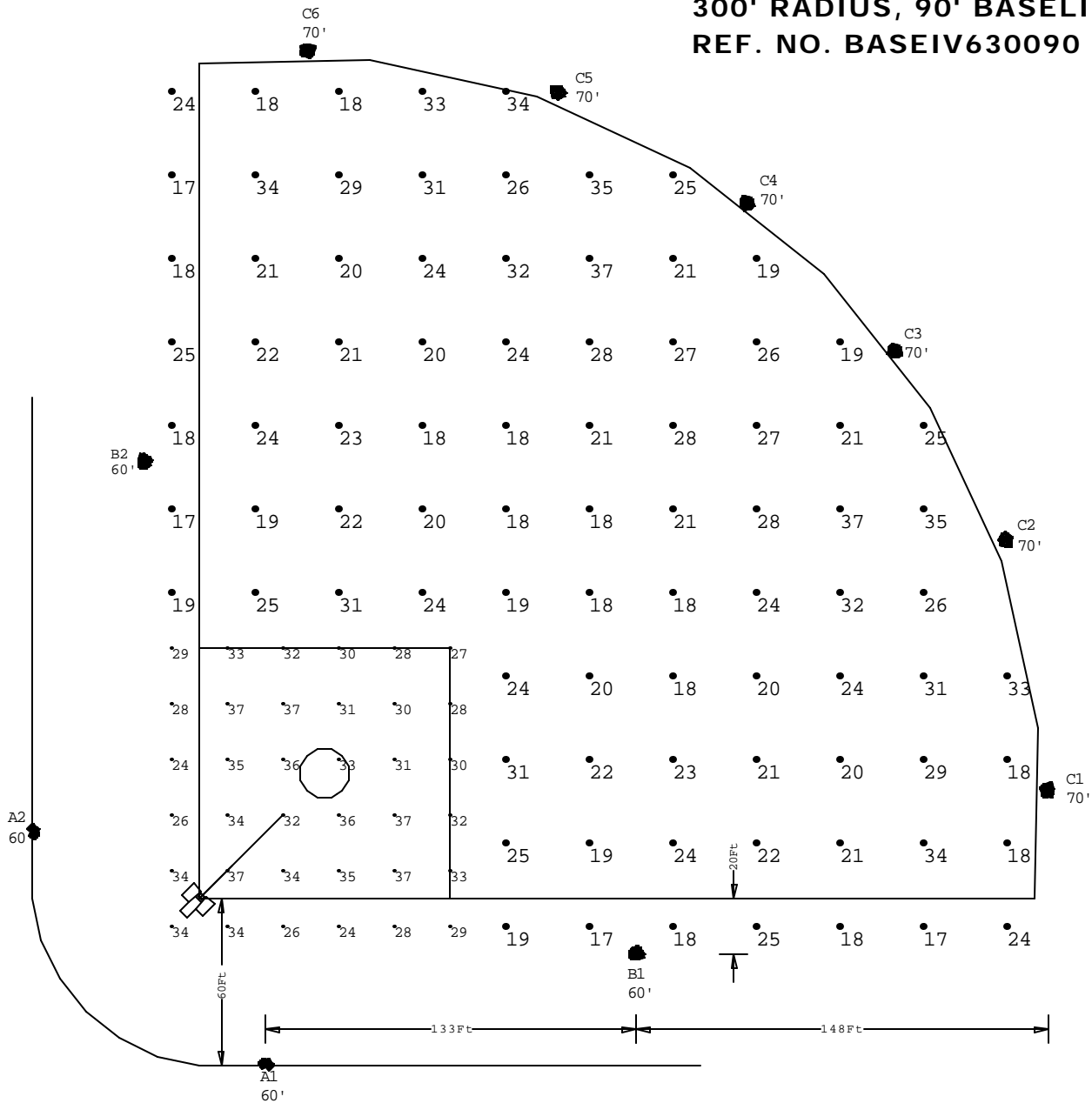

Luminaire Schedule						
Project: All Projects						
Symbol	Qty	Label	Description	Lumens	LLF	Filename
[Symbol]	12	F2	9000-VN-1000MH	110000	0.720	1kmh3030.ies
[Symbol]	36	F3	9000-VM-1000MH	110000	0.720	9000VM1000MH.IES
[Symbol]	12	F6	9000-VW-1000MH	110000	0.720	9000VW1000MH.IES

Numeric Summary - Basic										
Project: All Projects										
Label	CalcType	Units	Avg	Max	Min	Avg/Min	Max/Min	# Pts	CV	Description
INFIELD	Illuminance	Fc	31.69	37	24	1.32	1.54	36	0.12	readings taken at 3' avg
OUTFIELD	Illuminance	Fc	23.64	37	17	1.39	2.18	87	0.20	readings taken at 3' avg

View\_1:Plan Rotated 0 Tilted 0  
Scale: 1 inch= 60 Ft.

ABS LIGHTING- This layout provided using manufacturer's photometrics. Variations between installation and this layout will result in variations from footcandle levels shown.



# Fixture Breakdown per Pole

File: BASEIV630090

9000-XS-1000MH	9000-VN-1000MH	9000-VM-1000MH	9000-VW-1000MH
F1	F2	F3	F6

Pole	Mtg. Ht.	F1	F2	F3	F6
A1	50		2	4	
A2	50		2	4	
B1	50		2	6	1
B2	50		2	6	1
C1	60		2	2	1
C2	60			3	2
C3	60			3	2
C4	60			3	2
C5	60			3	2
C6	60		2	2	1
<b>Total</b>			<b>12</b>	<b>36</b>	<b>12</b>