

NOTES:

- 1) EXACT MOUNTING DETAILS TO BE DETERMINED AT JOBSITE BY OTHERS.
- 2) CALCULATIONS DO NOT SHOW THE EFFECT OF SHADOWING CAUSED BY OBJECTS WITHIN THE AREA.

**BASEBALL TYPICAL
YOUTH LEAGUE
CLASS IV, 4 OUTFIELD POLES
180' RADIUS, 60' BASELINE
REF. NO. BASEIV41806031
USING 3100 SERIES**

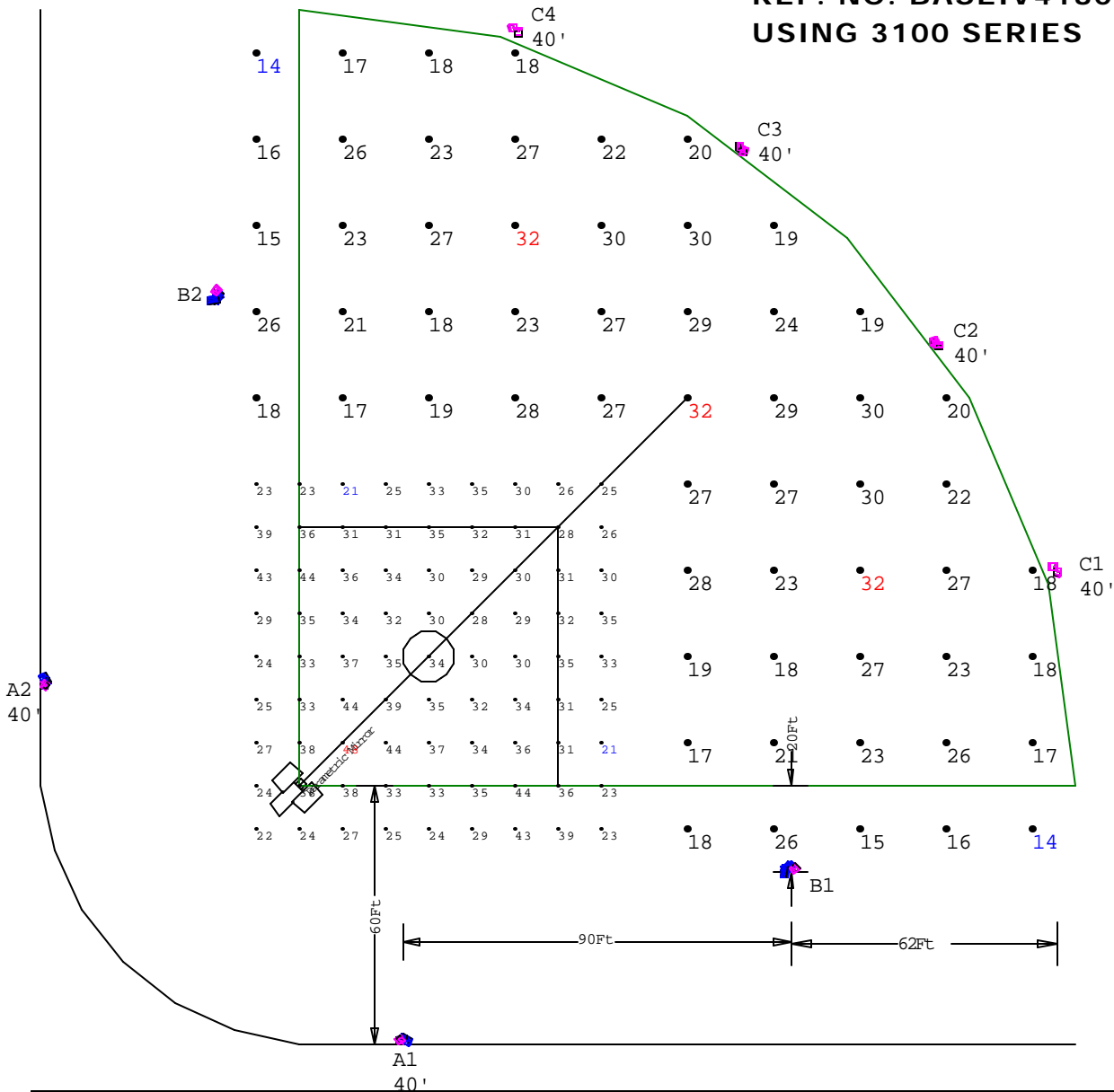

Luminaire Schedule						
Project: All Projects						
Symbol	Qty	Label	Description	Lumens	LIF	Filename
	10	F7	ABS 3100-HM-1000MH	110000	0.720	3100HM1000MH.IES
	14	F11	ABS 3100-HWR-1000MH	110000	0.720	3100HWR400MH.IES

Numeric Summary - Basic										
Project: All Projects										
Label	CalcType	Units	Avg	Max	Min	Avg/Min	Max/Min	# Pts	CV	Description
Infield	Illuminance	Fc	31.93	48	21	1.52	2.29	81	0.19	3' above grade
outfield	Illuminance	Fc	22.69	32	14	1.62	2.29	58	0.17	3' above grade

View_1:Plan Rotated 0 Tilted 0
Scale: 1 inch= 40 Ft.

ABS LIGHTING- This layout provided using manufacturer's photometrics. Variations between installation and this layout will result in variations from footcandle levels shown.



Fixture Breakdown per Pole

File: BASEIV41806031

3100-HM-1000MH	3100-HMR-1000MH	3100-HN-1000MH	3100-XN-1000MH	3100-HWR-1000MH
F7	F8	F9	F10	F11

Pole	Mtg. Ht.	F7	F8	F9	F10	F11
A1	40	2				1
A2	40	2				1
B1	40	3				1
B2	40	3				1
C1	40					2
C2	40					3
C3	40					3
C4	40					2
Total		10	0	0	0	14