

**NOTES:**

- 1) EXACT MOUNTING DETAILS TO BE DETERMINED AT JOBSITE BY OTHERS.
- 2) CALCULATIONS DO NOT SHOW THE EFFECT OF SHADOWING CAUSED BY OBJECTS WITHIN THE AREA.

**BASEBALL TYPICAL  
YOUTH LEAGUE  
CLASS IV, 4 OUTFIELD POLES  
180' RADIUS, 60' BASELINE  
REF. NO. BASEIV418060**

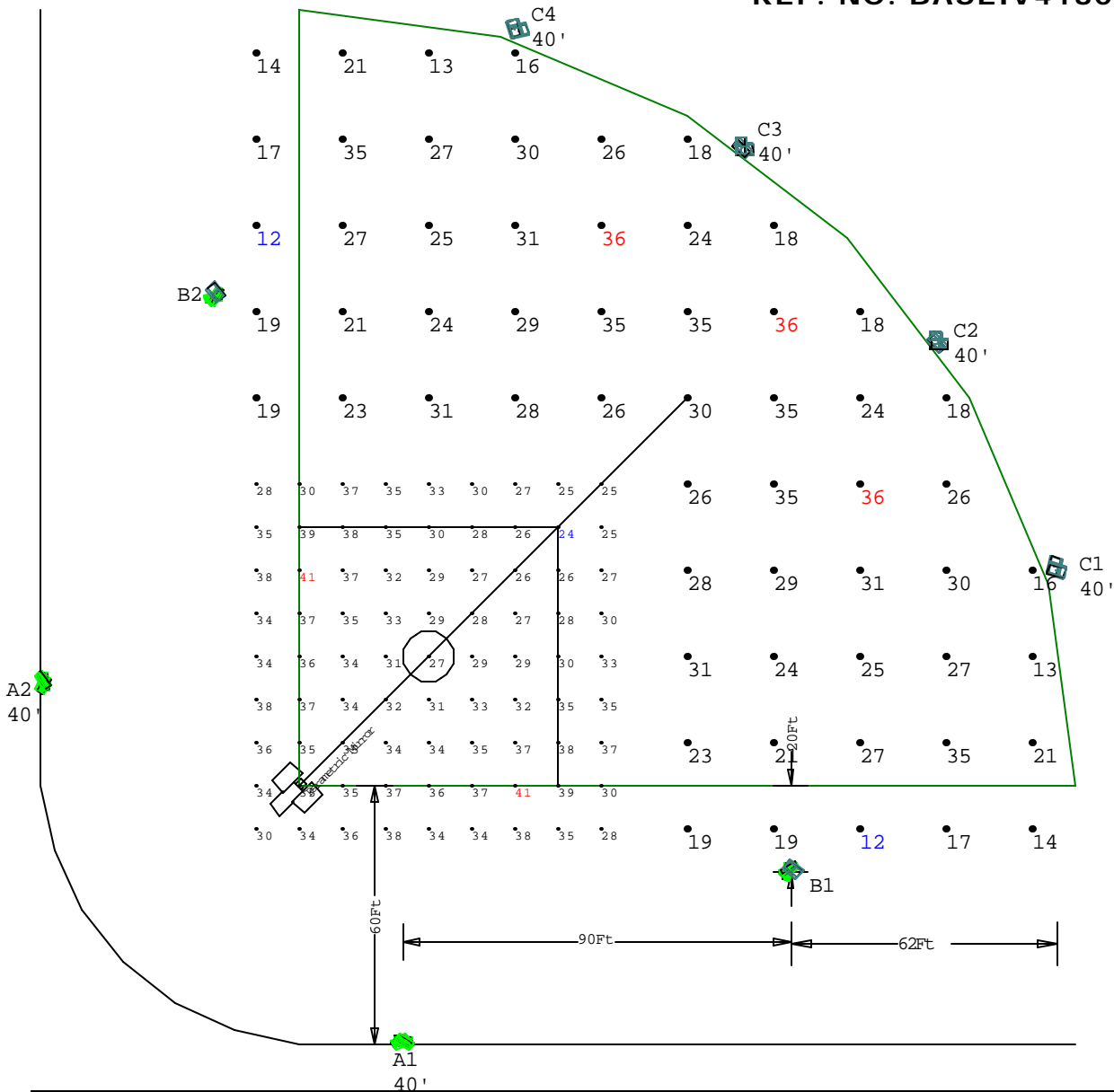

Luminaire Schedule						
Project: All Projects						
Symbol	Qty	Label	Description	Lumens	LIF	Filename
F3	14	F3	9000-VM-1000MH	110000	0.720	9000VM1000MH.IES
F6	12	F6	9000-VW-1000MH	110000	0.720	9000VW1000MH.IES

Numeric Summary - Basic										
Project: All Projects										
Label	CalcType	Units	Avg	Max	Min	Avg/Min	Max/Min	# Pts	CV	Description
Infield	Illuminance	Fc	32.79	41	24	1.37	1.71	81	0.13	3' above grade
outfield	Illuminance	Fc	24.59	36	12	2.05	3.00	58	0.22	3' above grade

View\_1:Plan Rotated 0 Tilted 0  
Scale: 1 inch= 40 Ft.

ABS LIGHTING- This layout provided using manufacturer's photometrics. Variations between installation and this layout will result in variations from footcandle levels shown.



# Fixture Breakdown per Pole

File: BASEIV418060

9000-XS-1000MH	9000-VN-1000MH	9000-VM-1000MH	9000-VW-1000MH
F1	F2	F3	F6

Pole	Mtg. Ht.	F1	F2	F3	F6
A1	40			4	
A2	40			4	
B1	40			3	1
B2	40			3	1
C1	40				2
C2	40				3
C3	40				3
C4	40				2
<b>Total</b>				<b>14</b>	<b>12</b>