

**NOTES:**

- 1) EXACT MOUNTING DETAILS TO BE DETERMINED AT JOBSITE BY OTHERS.
- 2) CALCULATIONS DO NOT SHOW THE EFFECT OF SHADOWING CAUSED BY OBJECTS WITHIN THE AREA.

**BASEBALL TYPICAL  
YOUTH LEAGUE  
CLASS II, 2 OUTFIELD POLES  
180' RADIUS, 60' BASELINE  
REF. NO. BASEII21806031  
USING 3100 SERIES**

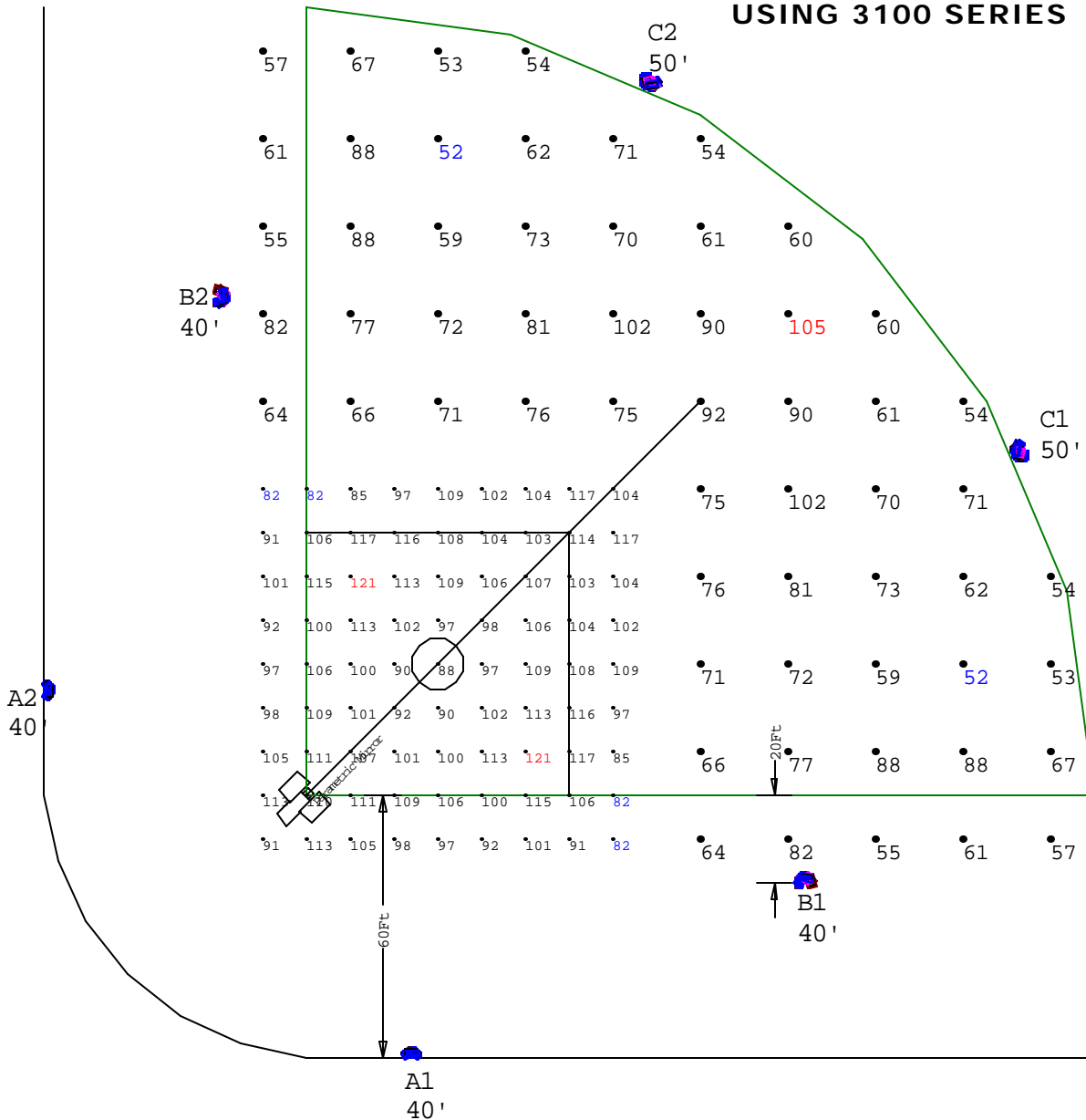

Luminaire Schedule						
Project: All Projects						
Symbol	Qty	Label	Description	Lumens	LLF	Filename
	50	F7	ABS 3100-HM-1000MH	110000	0.720	3100HM1000MH.IES
	12	F11	ABS 3100-HWR-1000MH	110000	0.720	3100HWR400MH.IES
	12	F10	ABS 3100-XN-1000MH	110000	0.720	3100XN1000MH.IES

Numeric Summary - Basic											
Project: All Projects											
Label	CalcType	Units	Avg	Max	Min	Avg/Min	Max/Min	#	Pts	CV	Description
outfield	Illuminance	Fc	70.33	105	52	1.35	2.02	58	0.15		readings taken at 3' afg
Infield	Illuminance	Fc	103.15	121	82	1.26	1.48	81	0.09		3' above grade

View\_1:Plan Rotated 0 Tilted 0  
Scale: 1 inch= 40 Ft.

ABS LIGHTING- This layout provided using manufacturer's photometrics. Variations between installation and this layout will result in variations from footcandle levels shown.



# Fixture Breakdown per Pole

File: BASEII21806031

3100-HM-1000MH	3100-HMR-1000MH	3100-HN-1000MH	3100-XN-1000MH	3100-HWR-1000MH
F7	F8	F9	F10	F11

Pole	Mtg. Ht.				
A1	40	9		2	
A2	40	9		2	
B1	40	6		4	2
B2	40	6		4	2
C1	50	10		0	4
C2	50	10		0	4
<b>Total</b>		<b>50</b>	<b>0</b>	<b>0</b>	<b>12</b>